

CORRECT INSTALLATION/RICHTIGE MONTAGE

Type/Typ Z10

Installation/Montage

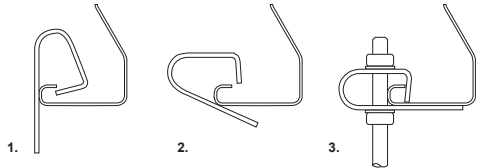
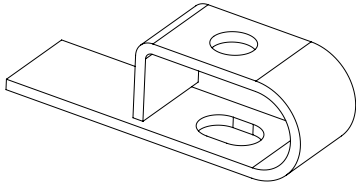

Suitable for use with the following purlins:

Einsetzbar bei nachfolgenden Pfetten:

Convient pour une utilisation avec les types de pannes suivants :

- Kingspan Multibeam 2 & 3
- Metsec
- Zeta

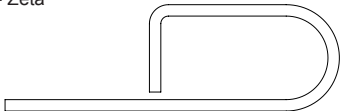

Product Code Artikelnummer Code Produit	Rod Gewindestange Tige	Tightening Torque Anziehmoment Couple Nm
Z10	M10	8

Product Code	Rod	Tightening Torque ft lb
Z10	3/8"	6

For safe working loads refer to www.lindapter.com.

Bitte entnehmen Sie die zulässigen Betriebslasten der gültigen Internetseite www.lindapter.com.

Pour les charges maximum applicables se reporter au www.lindapter.com.

CORRECT INSTALLATION/RICHTIGE MONTAGE

Type/Typ HCW30

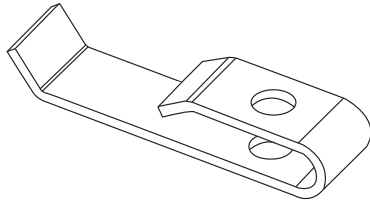

Installation/Montage

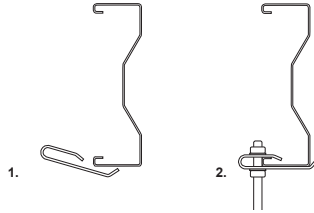

Product Code Artikelnummer Code Produit	Purlins Geeignete Pfetten Pannes	Rod Gewindestange Tige	Tightening Torque Anziehmoment Couple Nm
HCW30	Kingspan Multibeam 3	M10	8

Ref. HC12-1 (Aug.2012)

Type/Typ HCW31

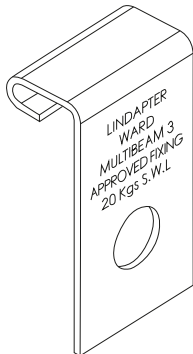

Installation/Montage

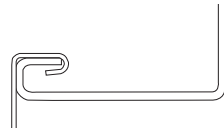

Product Code Artikelnummer Code Produit	Purlins Geeignete Pfetten Pannes
HCW31	Kingspan Multibeam 3

For safe working loads refer to www.lindapter.com.

Bitte entnehmen Sie die zulässigen Betriebslasten der gültigen Internetseite www.lindapter.com.

Pour les charges maximum applicables se reporter au www.lindapter.com.